



Features/Benefits

Models Available

- Long life—1,000,000 cycles
- Highly reliable contact design
- Process sealed—solder-proof and wash-proof
- Positive tactile feedback
- Thru-hole and surface mount models available

Typical Applications

- Medical Equipment
- Hand-held devices
- Instrumentation equipment

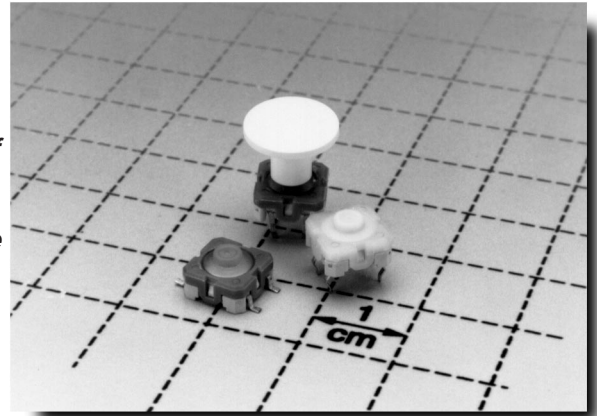

How To Order

To order Racon 8, select switch/housing part number. To order Racon 8 H, select switch part number and plunger part number in catalog section L. These tactile switches are suitable for most common soldering techniques. Surface mount models can be mounted with automatic assembly machines. Other operating forces available, consult Customer Service Center.

Specifications

CONTACT RATING: 0.01 - 100 mA @ 0.02 - 42 V AC/DC.

RATED POWER: 1 W max. resistive load.

CONTACT RESISTANCE: < 100 milliohms when new.

BOUNCE: < 5 ms.

CONTACT SYSTEM: Snap-action contact.

CONTACT ARRANGEMENT: SPST NO.

FIXING: By soldering.

OPERATING LIFE: 1,000,000 cycles min.

OPERATING FORCE: 2.5 + 0.7/- 0.5 N.

SWITCHING TRAVEL: 0.6 ± 0.2 mm.

AMBIENT OPERATING TEMPERATURE: - 40°C to + 80°C.;
- 40°F to + 176°F.

AMBIENT STORAGE TEMPERATURE: - 50°C to + 85°C;
- 58°F to + 185°F.

DEGREE OF PROTECTION: Solder-proof, wash-proof.

MOUNTING: SMT models can be mounted by automatic assembly machines.

PACKAGING: 8 & 8H thru-hole: Tube packaging, 65 switches;
8 SMD: Tape & reel packaging, 1,000 switches;
8H SMD: Tape & reel packaging, 750 switches.

Materials

SWITCH HOUSING: LCP.

COVER: PTS.

CONTACT MATERIAL: Au.

TERMINALS: Tin-plated.

FLAMMABILITY OF PLASTIC MATERIALS: UL 94 HB.

Racon 8

Outward Solder Terminals for PCB

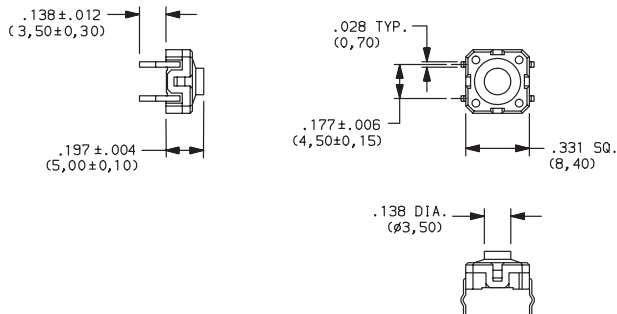

PC MOUNTING

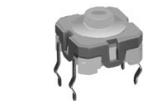
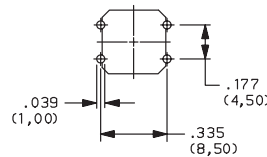

1.14100.0010000
SPST N.O.

SWITCH & HOUSING		
PART NUMBER	FUNCTION	SCHEMATIC
1.14100.0010000	SPST N.O.	

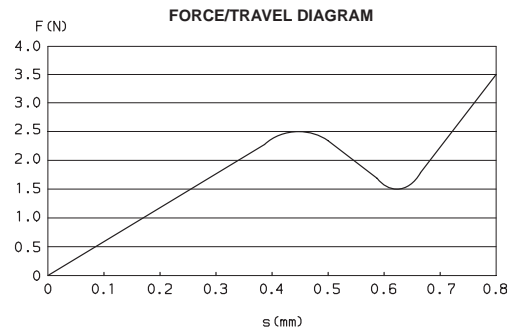

C

Tactile

Racon 8 & 8 H Series Short Travel Tactile Switches



Racon 8 Inward Solder Terminals for PCB



1.14100.0020000
SPST N.O.

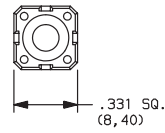
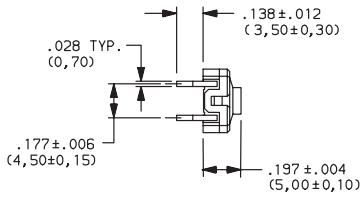

PC MOUNTING

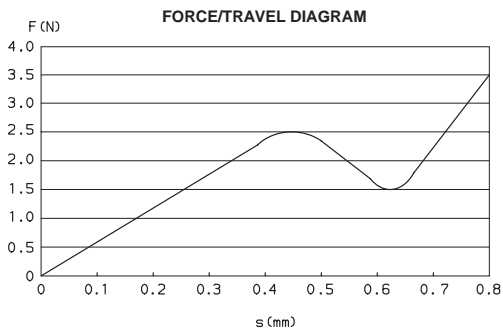
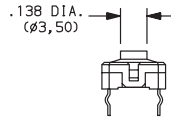
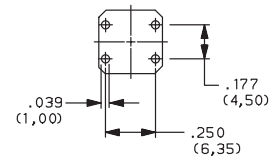

SWITCH & HOUSING		
PART NUMBER	FUNCTION	SCHEMATIC
1.14100.0020000	SPST N.O.	

Racon 8 SMD Terminals

SMT



1.14100.0030000
SPST N.O.

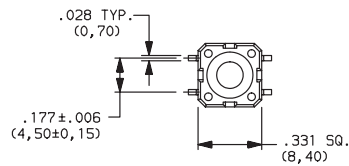

PC MOUNTING

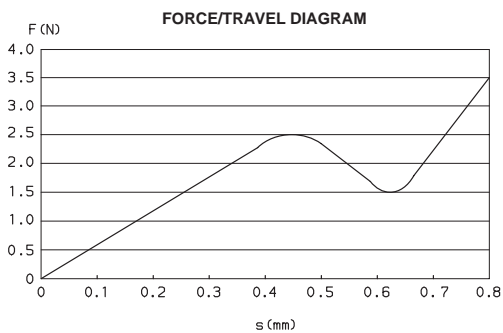
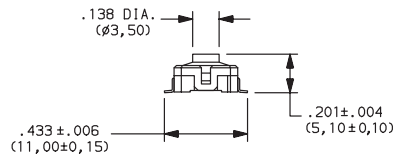
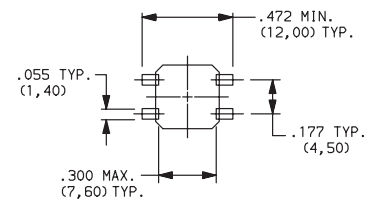

SWITCH & HOUSING		
PART NUMBER	FUNCTION	SCHEMATIC
1.14100.0030000	SPST N.O.	



Racon 8 H Inward Solder Terminals for PCB

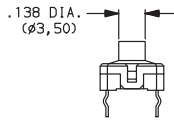
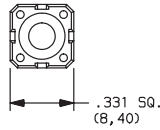
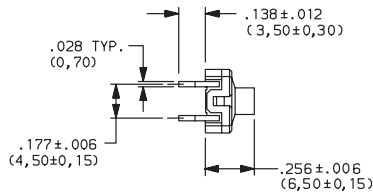

PC MOUNTING

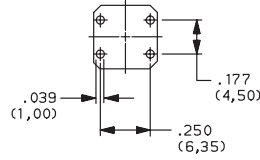

1.14100.0120000
SPST N.O.

PLUNGER



5.46067.090

SWITCH & HOUSING			PLUNGER ACCESSORY		
PART NUMBER	FUNCTION	SCHEMATIC	PART NUMBER	DIAMETER	OVERALL HEIGHT
1.14100.0120000	SPST N.O.		5.46067.0900000	8 mm	7.0 mm
			5.46067.0910000	8 mm	9.7 mm
			5.46067.0920000	8 mm	12.5 mm

FORCE/TRAVEL DIAGRAM

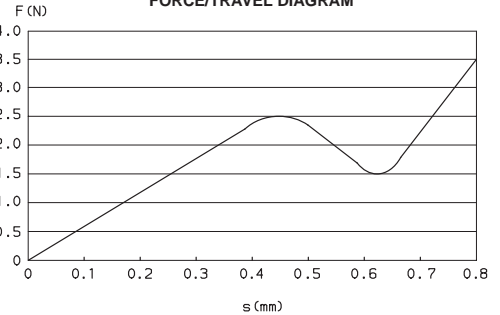

C

Tactile

Racon 8 H SMD Gullwing Terminals

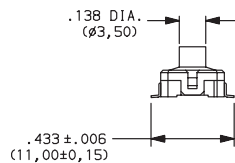
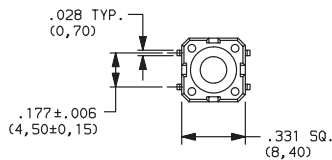
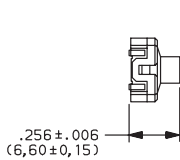

PC MOUNTING

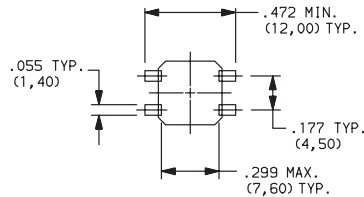

1.14100.0130000
SPST N.O.

PLUNGER



5.46067.090

SMT

SWITCH & HOUSING			PLUNGER ACCESSORY		
PART NUMBER	FUNCTION	SCHEMATIC	PART NUMBER	DIAMETER	OVERALL HEIGHT
1.14100.0130000	SPST N.O.		5.46067.0900000	8 mm	7.0 mm
			5.46067.0910000	8 mm	9.7 mm
			5.46067.0920000	8 mm	12.5 mm

FORCE/TRAVEL DIAGRAM

