



**Mallory Sonalert Products, Inc.**

Part #:

**MSR516WR**

**Sales Outline Drawing**

Revision:

C

Spec

# OBSOLETE- CONTACT MALLORY

Sound Level Category	Loud
Mode of Operation	Whooping Tone (5-7 Hz Sweep)
Voltage Rating	5 to 16 VDC
Frequency	3400 $\pm$ 400 Hz
Loudness @ 1 FT	86 to 94 dB(A) Typ.
Current Draw	3-12 mA
Housing Material	Valox (UL94V-0), Color Blue
Storage Temperature	-30° to +80° C
Operating Temperature	-20° to +65° C
Weight (Typical)	3.5g
Options	Please contact factory.

**Dimensions:** Inches (mm)

**ROHS Compliant**

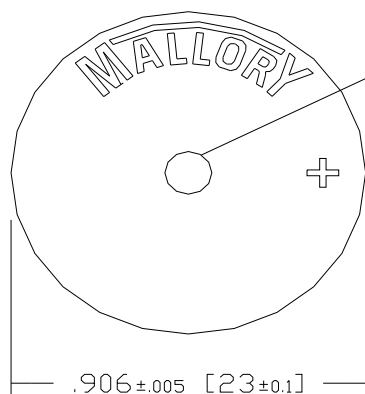

EMISSION HOLE  
 $\varnothing .120 \pm .005$  [3.0 $\pm$ 0.1]

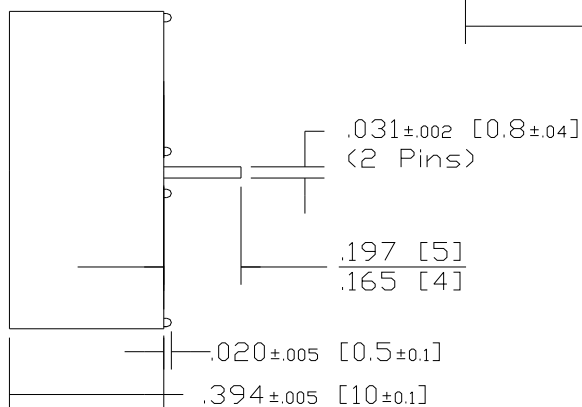
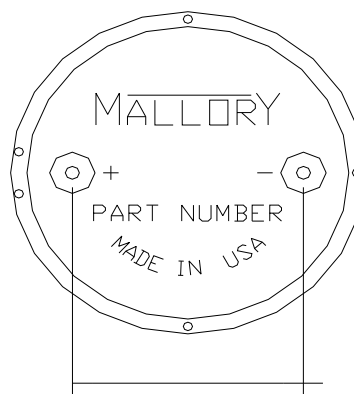

NOTE A:  
TERMINALS - .031" DIA. NICKEL/TIN COATED BRASS.

NOTE B:  
MOUNTING- INSERT INTO PRINTED CIRCUIT BOARD AND HAND OR MACHINE SOLDER.  
UNITS ARE SUITABLE FOR WAVE SOLDERING. RECOMMENDED MAXIMUM TEMPERATURE  
AND TIME DURATION FOR WAVE SOLDERING IS +270°C AND 3 SECONDS RESPECTIVELY.