

| REVISIONS | | | | | |
|-----------|------------------------|------|----------|------|------|
| REV. | DESCRIPTION | ECO | DATE | DRWN | APPD |
| A | RELEASE TO PRODUCTION. | 1418 | 11/09/09 | SC | JAS |

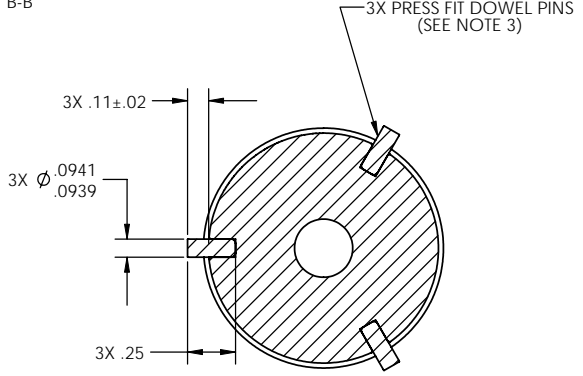
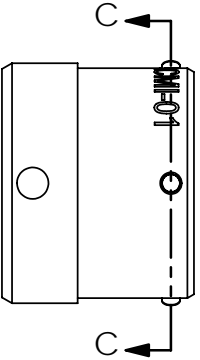
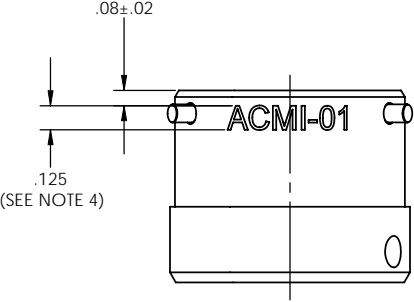
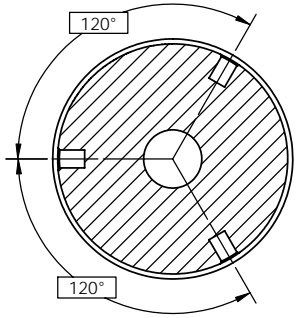
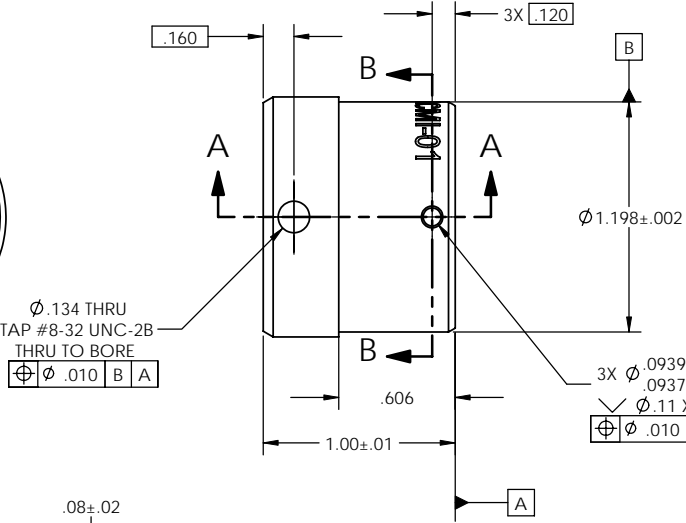
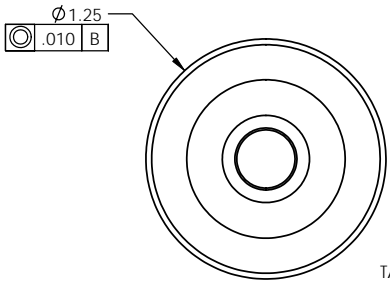
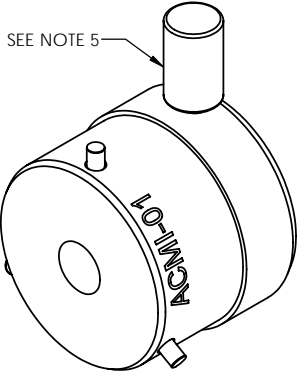
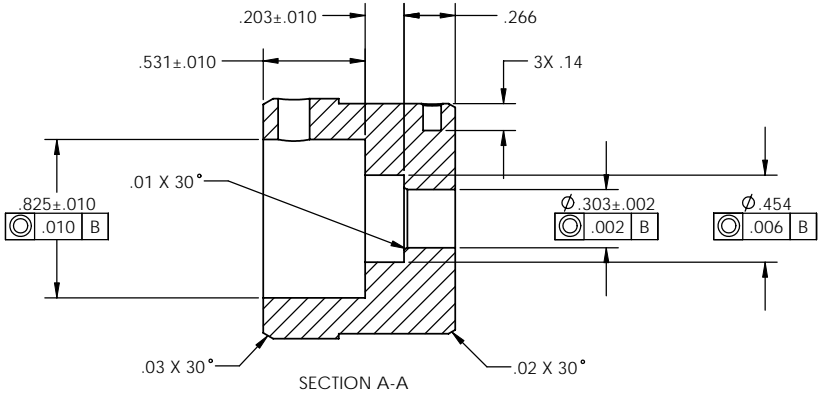

- NOTES:
1. MATERIAL: 6061 ALUMINUM.
 2. FINISH: CLEAR ANODIZED.
 3. AMERICAN NATIONAL STANDARD HARDENED GROUND MACHINE DOWEL PINS OR APPROVED EQUIVALENT. DOWEL PINS TO BE ZINC PLATED.
 4. LASER MARKINGS TO BE ARIAL FONT (.125 HIGH), CENTERED BETWEEN 2 DOWEL PINS AS SHOWN WITH RESPECT TO THE #8-32 TAP.
 5. THUMB SCREW (OPTO TECHNOLOGY P/N 63MT-0091) TO BE ASSEMBLED INTO #8-32 TAP AS SHOWN.
 6. PART TO BE FREE OF BURRS, SHARP EDGES AND FOREIGN MATERIAL.
 7. UNLESS OTHERWISE SPECIFIED ALL FEATURES SHALL HAVE A PROFILE TOLERANCE OF .010 ALL OVER WITH RESPECT TO DATUMS A & B.
 8. PART MUST BE ROHS COMPLIANT PER EUROPEAN UNION 2002/95/EC.
 9. SEE CAD MODEL 64MT-0533_A.STEP FOR ADDITIONAL DIMENSIONS.

PROPRIETARY AND CONFIDENTIAL
THE INFORMATION CONTAINED IN THIS DRAWING IS THE SOLE PROPERTY OF OPTO TECHNOLOGY INC. ANY REPRODUCTION IN PART OR AS A WHOLE WITHOUT THE WRITTEN PERMISSION OF OPTO TECHNOLOGY INC. IS PROHIBITED.

| UNLESS OTHERWISE SPECIFIED: | | | | OPTO TECHNOLOGY INC. | | | |
|--|--|--|--|---|--|--|--|
| DIMENSIONS ARE IN INCHES TOLERANCES: | | | | 160 E. Marquardt Drive, Wheeling IL 60090 | | | |
| ANGULAR: ±1 DEG | | | | TITLE: | | | |
| TWO PLACE DECIMAL ±.010 | | | | ADAPTOR, | | | |
| THREE PLACE DECIMAL ±.005 | | | | .299" DIA X .354" LG | | | |
| FURNISH COATING TOLERANCING PER ASME Y14.5M 1994 | | | | FERRULE, (ACMI-01) | | | |
| MATERIAL: | | | | SIZE | | | |
| FINISH: | | | | DWG. NO. | | | |
| NEXT ASSY | | | | 64MT-0533 | | | |
| USED ON: | | | | REV | | | |
| APPLICATION | | | | A | | | |
| DO NOT SCALE DRAWING | | | | SCALE: 2:1 | | | |
| | | | | WEIGHT: | | | |
| | | | | SHEET 1 OF 1 | | | |