

**Schematic**

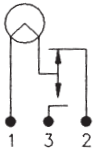

( ) P4 Cap

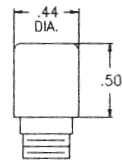

( ) P5 Cap

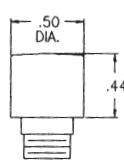

**Material and Finishes**

Mounting tube and nuts, aluminum, black anodized per MIL-A-8625A. Lockwasher, stainless steel. Brass terminals, tin plated per MIL-T-10727A.

**Cap Assembly**

Lens, high impact-resistant plastic per L-P-349.

**Lamp**

T-1 ¾ midget flange base. See Lamp Selection Guide.

**Mounting**

Assembly mounts from rear of panel. All mounting hardware supplied. Recommended mounting hole .500 in. ±.015 in. dia.

**Weight**

Approximately .4 oz. less lamp.

**03-91080 Type  
Incandescent Miniature  
General Purpose  
Size T-1 ¾**

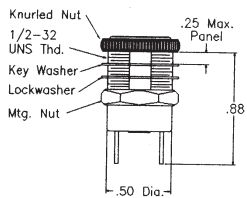
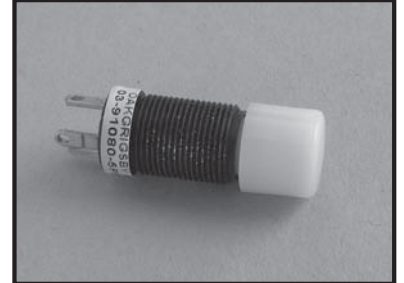

**Panel Cutouts**

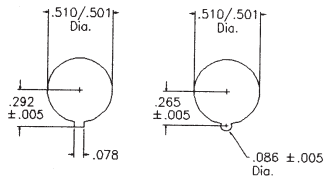

Circular

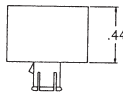

Rectangular

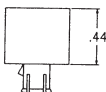
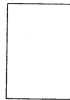

Square

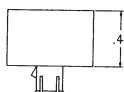

**Schematic**

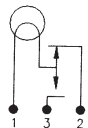

**Material and Finishes**

Mounting tube and knurled nut, clear anodized per MIL-A-8625A.

Mounting nut and key washer, brass, nickel plate. Lockwasher, stainless steel or steel, nickel plate. Brass terminals, tin plated per MIL-T-10727A.

**Cap Assembly**

Lens, high impact-resistant plastic per L-P-349. Friction fit lens caps, rotatable or keyed. Uses Presslite friction cap pushbuttons.

**Lamp**

T-1 ¾ midget flange base.

**Mounting**

Assembly mounts from rear of panel. All mounting hardware supplied. Recommended mounting hole, see drawing.

**Weight**

Approximately .5 oz. less lamp.

**59-52280 Type  
Incandescent Miniature  
Optional Press to Test  
Size T-1 ¾**

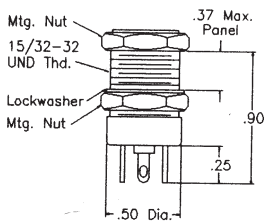
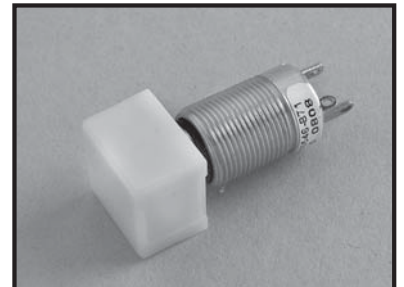

**Schematic**

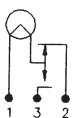

Dimmer Cap  
10850M-( )

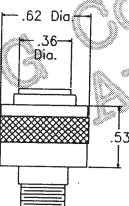

Non-Dim Cap  
10850M-( )

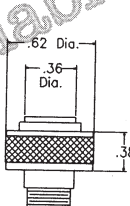

**Material and Finishes**

Mounting tube and nuts, aluminum, black anodized per MTL-A-8625A. Lockwasher, stainless steel. Brass terminals, tin plated per MIL-T-10727A.

**Cap Assembly**

Lens, high impact-resistant plastic per L-P-349, NVG Green, flat glass lens. Lens holders, aluminum, black anodized.

**Lamp**

T-1 ¾ midget flange base.

**Mounting**

Assembly mounts from rear of panel. All mounting hardware supplied. Recommended mounting hole .500 in. ±.015 in. dia.

**Identification**

Identified with MS P/N and base assembly number.

**Weight**

Approximately .5 oz. less lamp.

**01-91180 Type  
Originally designed  
to meet MS 25041  
Incandescent Miniature  
Size T-1 ¾**



### 03-90980 Type Incandescent Miniature Size T-1 3/4



#### Material and Finishes

Mounting tube, black glass filled nylon per MIL-M-19887. Mounting nut aluminum, black anodized per MIL-A-8625A. Lockwasher, stainless steel or steel, nickel plate. Brass terminals, tin plated per MIL-T-10727A.

#### Cap Assembly

Lens, high impact-resistant plastic per L-P-349. Lens holders are aluminum, black anodized.

#### Lamp

T-1 3/4 midget flange base.

#### Mounting

Assembly mounts from front of panel. All mounting hardware supplied. Recommended mounting hole .500 in. +/- .015 in. dia.

#### Weight

Approx. .9 oz. less lamp.

#### BASE ASSEMBLY

03-90980

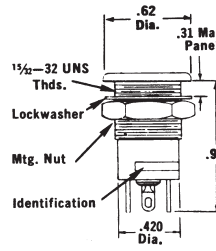

#### SCHEMATIC



#### CAP STYLES

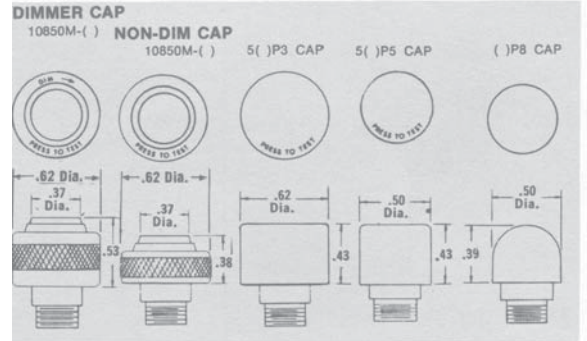

### 02-91180 Type Originally designed to meet MS 25331 Incandescent Standard Size T-3 1/4



#### Material and Finishes

Mounting tube and nuts, aluminum, black anodized per MIL-A-8625A. Lockwasher, stainless steel. Brass terminals, tin plated per MIL-T-10727A.

#### Cap Assembly

Lens is high impact-resistant plastic per L-P-349. Lens holders, aluminum, black anodized.

#### Lamp

T-3 1/4 miniature bayonet base.

#### Mounting

Assembly mounts from rear of panel. All mounting hardware supplied. Recommended mounting hole .640 in. +/- .015 in. dia.

#### Identification

Identified with MS P/N and base assembly number

#### Weight

Approximately .8 oz. less lamp.

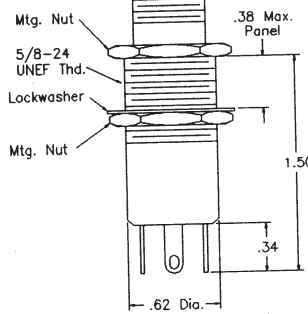

#### Schematic

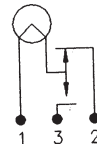

Dimmer Cap  
10850-( )

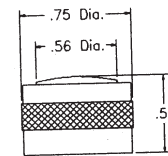

Non-Dim Cap  
10850-( )

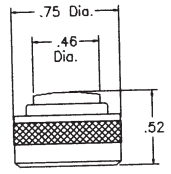

### 05-90880 Type 05-90881 Type Incandescent Miniature Watertight - Size T-1 3/4

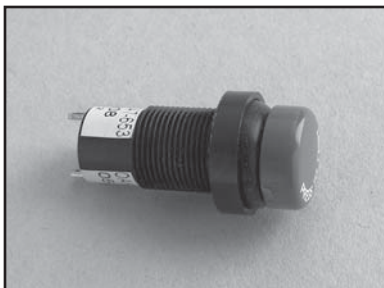

#### Material and Finishes

Mounting tube, black glass filled nylon per MIL-M-19887. Mounting nut aluminum, black anodized per MIL-A-8625A. Lockwasher, stainless steel or steel, nickel plate. Brass terminals, tin plated per MIL-T-10727A. Rubber boot and washer, silicone rubber.

#### Cap Assembly

Lens, high impact-resistant plastic per L-P-349. Lens holders are aluminum, black anodized.

#### Lamp

T-1 3/4 midget flange base.

#### Mounting

Assembly mounts from front of panel. All mounting hardware supplied. Recommended mounting hole .500 in. +/- .015 in. dia.

#### Weight

Approx. .3 oz. less lamp.

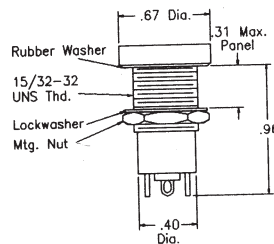

#### Schematic

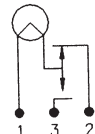

5( )WT7

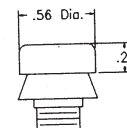

Dimmer Cap  
90852-( )

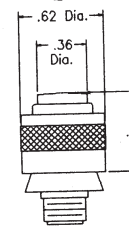

Non-Dim Cap  
90852-( )

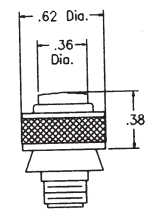

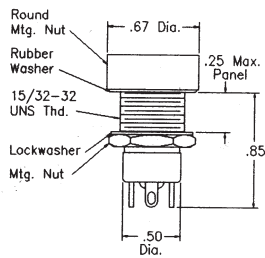

**Schematic**

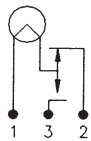

5 ( ) W17



Dimmer Cap  
90852- ( )



Non-Dim. Cap  
90852- ( )

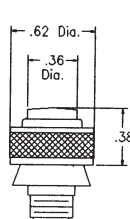
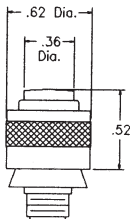
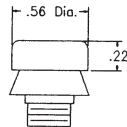

**Material and Finishes**

Mounting tube and nuts, aluminum, black anodized per MIL-A-8625A. Lockwasher, stainless steel or steel, nickel plate. Brass terminals, tin plated per MIL-T-10727A. Rubber boot and washer, silicone rubber.

**Cap Assembly**

Lens, high impact-resistant plastic per L-P-349. Lens holders are aluminum, black anodized.

**Lamp**

T-1 3/4 midget flange base.

**Mounting**

Assembly mounts from rear of panel. All mounting hardware supplied. Recommended mounting hole .500 in.  $\pm$  .015 in. dia.

**Weight**

Approximately .44 oz. less lamp.

**05-91182 Type  
Incandescent Miniature  
Watertight - Size T-1 3/4**

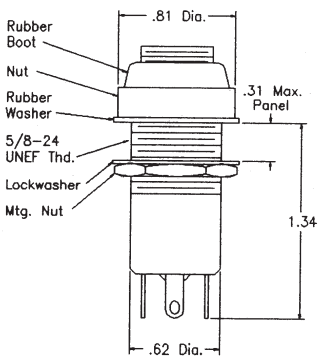

**Schematic**

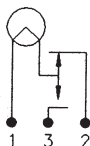

Dimmer Cap  
10854- ( )



Non-Dim. Cap  
10854- ( )

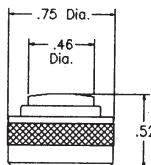
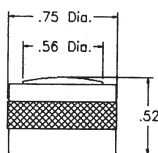

**Material and Finishes**

Mounting tube and nuts, aluminum, black anodized per MIL-A-8625A. Lockwasher, stainless steel or steel, nickel plate. Brass terminals, tin plated per MIL-T-10727A. Rubber boot and washer, silicone rubber.

**Cap Assembly**

Lens, high impact-resistant plastic per L-P-349. Lens holders, aluminum, black anodized.

**Lamp**

T-3 1/4 miniature bayonet base.

**Mounting**

Assembly mounts from rear of panel. All mounting hardware supplied. Recommended mounting hole .640 in.  $\pm$  .015 in. dia.

**Weight**

Approximately .85 oz. less lamp.

**06-91182 Type  
Incandescent Watertight  
Size T-3 1/4**

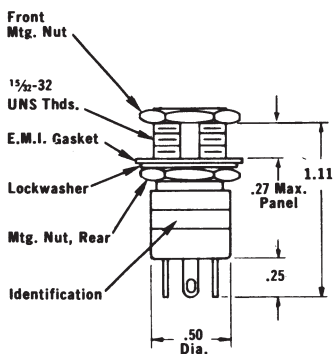

**PANEL CUTOUT**



**SCHEMATIC**

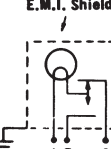

**DIMMER CAP**  
83250-8 ( )



**NON-DIM CAP**  
83250-8 ( )

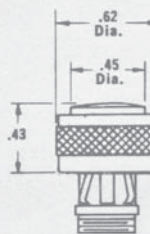
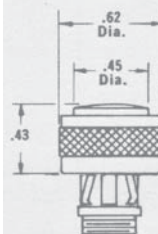

**Material and Finishes**

Lens holder and front mounting nut is black anodized per MIL-A-8625A. Mounting tube & rear Mtg. nut, is bright nickel plated per QQ-N-200. Lockwasher is stainless steel. Terminals brass, gold plated per MIL-G-45204.

**Cap Assembly**

Lens is high impact-resistant plastic per L-P-349. Lens holders are aluminum, black anodized.

**Lamp**

T-1 3/4 midget flange base.

**Mounting**

Assembly mounts from rear of panel. All mounting hardware supplied. Flat on Mtg. tube provides for keyed installation.

**Weight**

Approx. .5 oz less lamp.

**08-83281 Type  
Incandescent Miniature  
EMI Suppressed  
Size T-1 3/4**





### 08-83283 Type Incandescent Miniature EMI Suppressed Watertight Size T-1 3/4



#### Material and Finishes

Round mounting nut, aluminum, black anodized per MIL-A-8625A. Mounting tube and mounting nut, bright nickel plated per QQ-N-290. Lockwasher, steel, nickel plated. Rubber boot and washer, silicone rubber. Brass terminals, gold plated per MIL-G-45204.

#### Cap Assembly

Lens, high impact-resistant plastic per L-P-349. Lens holders, aluminum, black anodized.

#### Lamp

T-1 3/4 midjet flange base.

#### Mounting

Assembly mounts from rear of panel. All mounting hardware supplied. Flat on mounting tube provides for keyed installation.

#### Weight

Approximately .6 oz. less lamp.

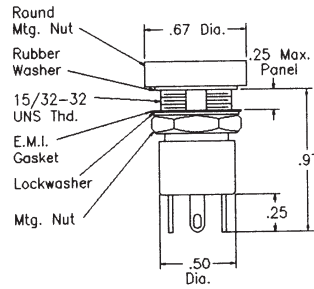

#### Panel Cutout

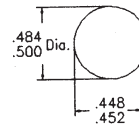

#### Schematics

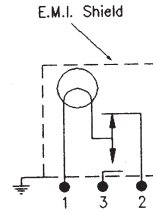

Dimmer Cap  
83250-8( )WT



Non-Dim Cap  
83250-8( )WT

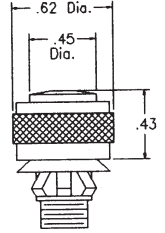
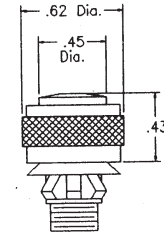

### 04-VM906 Type Incandescent General Purpose Size T-3 1/4



#### Material and Finishes

Mounting tube, aluminum, black anodized per MIL-A-8625A. Mounting nut, steel cad plate per QQ-C-416. Lockwasher, stainless steel or steel, nickel plate. Brass terminals, tin plated per MIL-T-10727A.

#### Cap Assembly

Lens, high impact-resistant plastic per L-P-349. Standard colors are semi-diffusing.

#### Lamp

T-3 1/4 miniature bayonet base.

#### Mounting

Assembly mounts from front of panel. All mounting hardware supplied. Recommended mounting hole .640 in. +/- .015 in. dia.

#### Weight

Approx. .55 oz. less lamp.

#### BASE ASSEMBLY

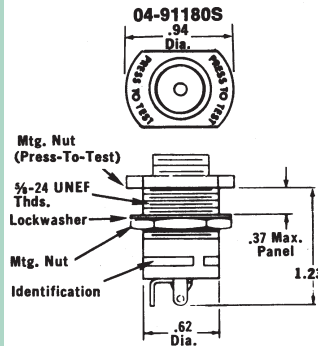

#### SCHEMATIC



#### CAP STYLES

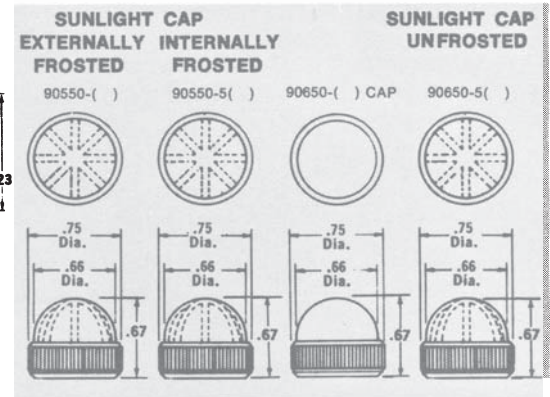

**BASE ASSEMBLY**  
**03-93480**

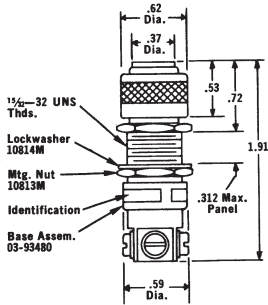

**SCHEMATICS**



**CAP STYLES**

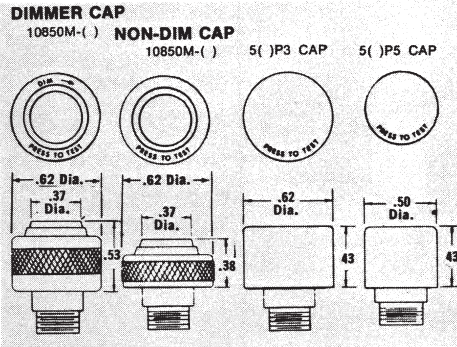

**Materials and Fiber**

Mounting tube and nuts are aluminum, black anodized per MIL-A-8625A. Lockwasher, stainless steel or steel, nickel plated. Terminals are 4-40 screws, nickel plate QQ-N-290.

**Cap Assembly**

Lens is high impact-resistant plastic per L-P-349a.

**Lamp**

T-1 3/4 midget flange base. Standard colors are transparent. Also available in translucent or diffusing caps.

**Mounting**

Assembly mounts from rear of panel. All mounting hardware supplied. Recommended mounting hole .500 ± .015 diameter.

**Weight**

Approximately .50 oz. less lamp.

**03-93480 Type**

**03-93481 Type**

**Incandescent Miniature**  
**General Purpose - Size T-1 3/4**



**Push In**

**Base Assembly**  
**99-33080**

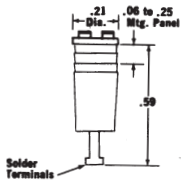

**Base Assembly**  
**99-33081**

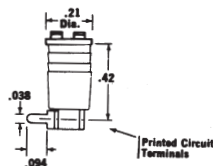

**Cap Styles**

**( ) P46 CAP**

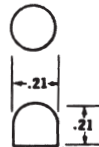

**( ) P47 CAP**

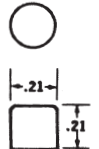

**Material and Finishes**

Housing and lamp base, gray glass filled nylon. Terminals, beryllium copper, gold flashed. Retainer clip, stainless steel.

**Lens Cap**

High impact-resistant plastic per L-P-393 (polycarbonate).

**Lamp**

T-1 wire terminal lamp; Lamp is replaced by removing snap-on cap.

**Mounting**

Press-in: Assembly press fits into .189 in. dia. hole. No mounting hardware required.

Retainer clip: For mounting assembly into .200 in. ± .005 in. dia. hole or panels less than .06 in. thick. Order clip 2-1186-643 separately.

**99-33080 Type**

**99-33081 Type**

**Incandescent Subminiature**  
**General Purpose - Size T-1**

