

Series A4000 & Series B4000

Single Row Terminal Blocks

SPECIFICATIONS

Rating: See table.

Center Spacing: .562" or 9/16" (14.28 mm)

Wire Size: See rating table.

Screw Size: #8-32 or #10-32 zinc plated screws

Torque Rating: #8 screw size 16 in-lb. max; #10 screw size 20 in-lb. max.

Distance Between Barriers: .47" (11.9 mm)

Operating Temperature: 105°C (221°F) max., -40°C (-40°F) min.

Molded Material: Black, UL Rated 94VO Thermoplastic

Hardware: Bottom studs supplied with nuts assembled.

Cup washers are optional on bottom studs but are not recommended with ring terminals.

Extended Hex Nuts: Optional extended, slotted hex nuts enable easier installation and removal with hex wrench or screwdriver. Available in bulk for the #10-32 studs on Series A4953 blocks. Specify part no. F582 and quantity.

Approvals: UL E62622; CSA LR15364; CE Certified

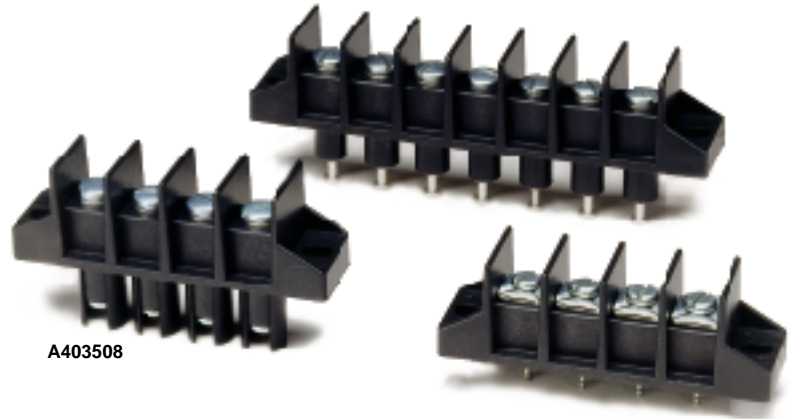

A403508

A4000 Series

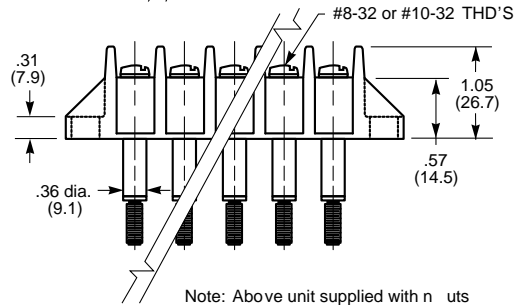
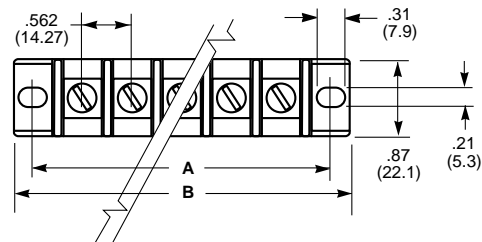

Note: Above unit supplied with nuts assembled. Cup washers are optional.

RATING TABLE

Part Number	Terminal Top	Terminal Bottom	Wire Range CU	Rated Voltage	Rated Current*
A4003XX	# 8 Screw	#8 Stud	10-16 AWG	150V; 50 amps	
A4011XX	# 8 Screw	Solder	10-16 AWG	600V; 35 amps	
A4013XX	# 8 Screw	Solder	10-16 AWG	600V; 35 amps	
A4021XX	# 8 Screw	.250 QC	10-16 AWG	600V; 35 amps	
A4035XX	# 8 Screw	Closed	10-16 AWG	600V; 50 amps	
A4041XX	#10 Screw	Solder	10-16 AWG	600V; 35 amps	
A4051XX	#10 Screw	250 QC	10-16 AWG	600V; 35 amps	
A4803XX	#10 Screw	#8 Stud	10-16 AWG	150V; 50 amps	
A4813XX	#10 Screw	Solder Turret	10-16 AWG	600V; 35 amps	
A4843XX	#10 Screw	#8 Screw	10-16 AWG	150V; 50 amps	
A4953XX	#10 Stud	#10 Stud	10-16 AWG	150V; 50 amps	
B4843XX	#10 Screw	#8 Screw	10-16 AWG	600V; 50 amps	

* All models 30A Max. with 10 AWG;

35-50A ratings with 8 AWG using ring or fork type terminals.

Note: 1. 50A rating achieved with #8 copper wire crimped to ring terminal.

2. Insulated ring terminal required for bottom termination on B4843XX.

Poles	A (in.) Mount Centers	B (in.) Length
2	1.69	2.12
3	2.25	2.68
4	2.81	3.24
5	3.37	3.80
6	3.93	4.36
7	4.50	4.93
8	5.06	5.34
9	5.62	6.05
10	6.18	6.61
11	6.74	7.17
12	7.31	7.74
13	7.87	8.30
14	8.43	8.86
15	8.99	9.44
16	9.55	9.98
17	10.12	10.55
18	10.68	11.11

* Dimensions in inches. To convert to millimeters, multiply by 25.4.

Optional Cup Washers Assembled

Available on A4003, A4803, A4843, A4953 & B4843.

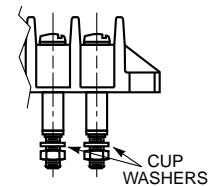

Reference Panel Cutout for 6 Position Block

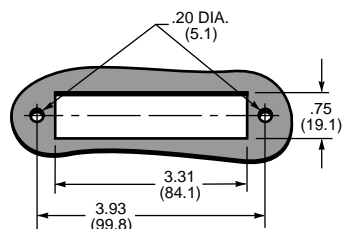

Part Numbering System

Series	Terminal Style	Base/End	Poles	Screw Options	Options
A A4 - standard B4 - barrier	n n 00 - screw top; stud bottom 01 - screw top; solder bottom 02 - #8 screw top; .250 QC bottom 03 - screw top only 04 - #10 screw top; solder term. b. 05 - #10 screw top; .250 QC bottom 80 - screw top; stud bottom insulated base 81 - screw top; solder turret bottom 84 - screw top; screw bottom 95 - stud top; stud bottom	n 1 - flat base/ mount end 3 - insulator base/ mount end 5 - closed base/ mount end	n n 02 to 18	n n Blank - std. screw 00 - screws shipped bulk 04 - brass nickel plated 07 - steel SEMS zinc plated (not available with hardware options; not available on A4003, A4803, A4813, A4843, B4843)	n n A1 to A9 - .250" QC CW - cup washer J301 - flat slip-on jumper (2 position only) L1 to L6 marking options (pg 23) S1 & S2 - solder lugs/flat

Terminal Styles

Inches (Millimeters)

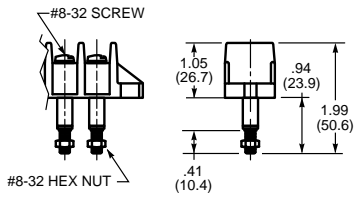

A4003XX

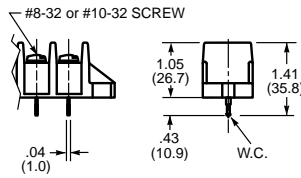

A4011XX (#8-32)
A4041XX (#10-32)

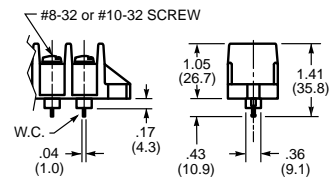

A4013XX (#8-32)
A4043XX (#10-32)

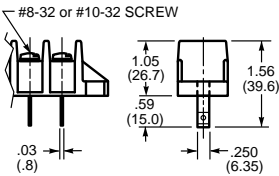

A4021XX (#8-32)
A4051XX (#10-32)

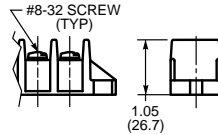

A4035XX

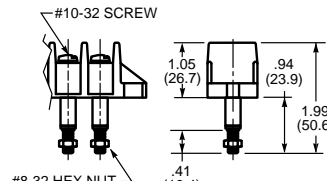

A4803XX

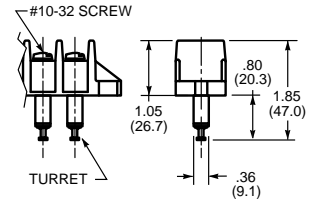

A4813XX

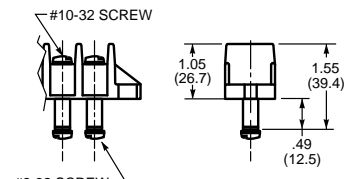

A4843XX

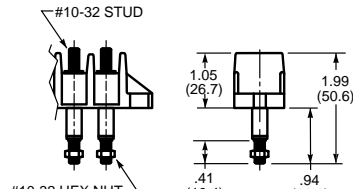

A4953XX

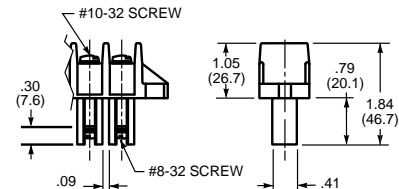

B4843XX

Hardware Options (Bulk ordering part numbers are in parentheses.)

Inches (Millimeters)

Solder Lugs

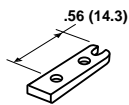

S1
(2S1)

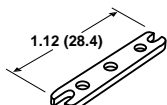

S2
(2S2)

Jumpers



J301

Quick Connects Blade Width A = .250". (For other orientations, contact factory.)

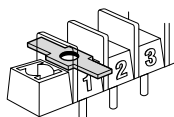

A1
(4A1)

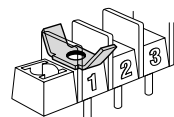

A2
(4A2)

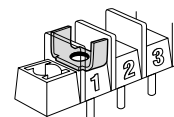

A3
(4A3)

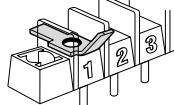

A4
(4A4)

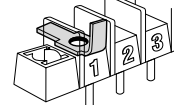

A5
(4A5)



A6
(4A6)

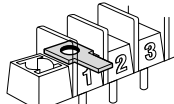

A7
(4A7)

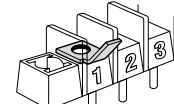

A8
(4A8)

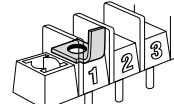

A9
(4A9)