



## 110-240 V MICRODRIVERS



### FEATURES / BENEFITS

- ▲ Energy efficient switch mode power electronics
- ▲ Short and open circuit protected
- ▲ Small compact size
- ▲ Rugged design with terminal cover & cable grip
- ▲ Over-voltage protection
- ▲ Resetting thermal shutdown safety feature
- ▲ UL recognized component
- ▲ Meets lighting approbation requirements (CE & ENEC)

### OPERATING CONDITIONS

- ▲ Operating Ambient Temperature: -20°C to +45°C (-4°F to +113°F)
- ▲ Ambient Storage Temperature: -20°C to +80°C (-4°F to +176°F)
- ▲ Maximum Case Temperature: <+85°C (185°F)
- ▲ Input Voltage 110-240Vac 50 / 60 Hz
- ▲ V<sub>out</sub> : MDU4 = 4-15VDC, MDU9 = 4-32VDC

### APPLICATIONS

- ▲ Architectural lighting
- ▲ Cove & cornice lighting
- ▲ Display case lighting
- ▲ Signage
- ▲ Reading lamps
- ▲ Marker & orientation lights
- ▲ Landscape lighting
- ▲ Refrigeration lighting

### PART NUMBERS

Part Number	Description	LED Configuration
MDU4-SC-35	MicroDriver 4 SC	1-4 1 Watt LEDs
MDU9-SC-3570	MicroDriver 9 SC	1-9 1 Watt LEDs <u>or</u> 1-4 3 Watt LEDs

Dialight reserves the right to make changes at any time in order to supply the best product possible.

**Dialight Corporation**

1501 Route 34 South • Farmingdale, NJ 07727 USA

Tel: (1) 732-919-3119 • Fax: (1) 732-751-5778 • www.dialight.com



MEDEXLUMMD\_C

### MECHANICAL DRAWING

#### PHYSICAL ASSEMBLY

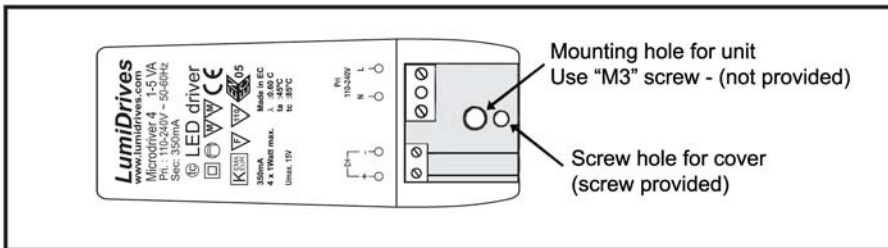

Easily removable cover

#### MDU4-SC-35 - 1 x 4 LEDs (350mA)

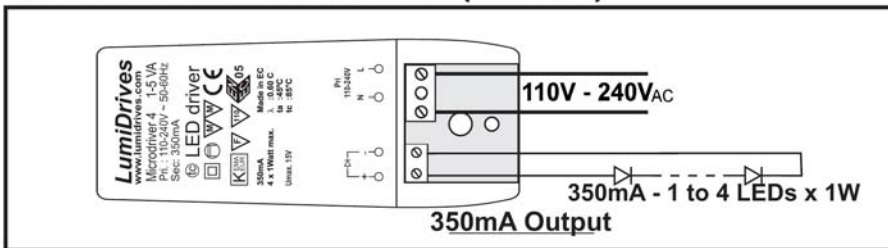

Input and output screw terminations

#### MDU9-SC-35/70 - 1 x 9 LEDs (350mA)

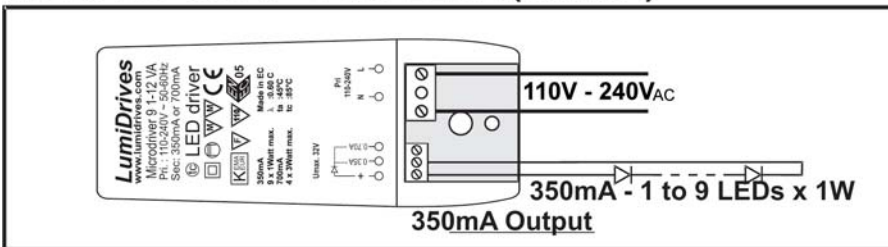

#### MDU9-SC-35/70 1 x 4 LEDs (700mA)

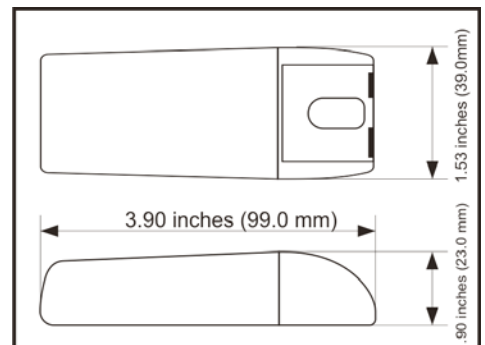
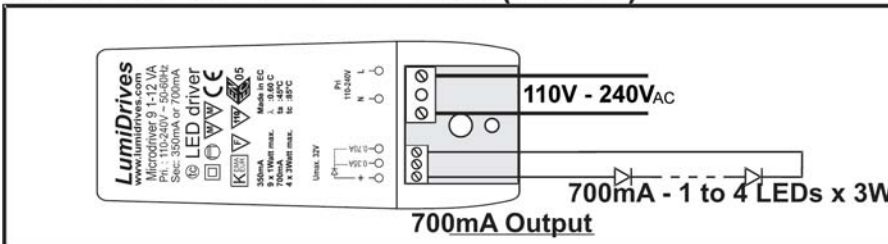

Dialight reserves the right to make changes at any time in order to supply the best product possible.

Dialight Corporation

1501 Route 34 South • Farmingdale, NJ 07727 USA

Tel: (1) 732-919-3119 • Fax: (1) 732-751-5778 • www.dialight.com



MEDEXLUMMD\_C