



SERIES: 15 W MULTI-BLADE

DESCRIPTION: SWITCHING POWER SUPPLY

FEATURES

- universal AC input
- regulated output voltage
- interchangeable input blades
- short circuit, over load protection
- meets EISA / efficiency level IV regulations
- custom designs available



MODEL

| MODEL | output voltage | | output current | | output wattage | ripple* | efficiency level | cord length (mm) |
|-----------|-------------------|--|----------------|------------|----------------|-----------------|------------------|---------------------|
| | nominal (V dc) | | min (A) | max (A) | max (W) | max. (mVp-p) | | |
| EMS050260 | 5 | | 0 | 2.6 | 13 | 150 | IV | 1830 +150/-0 |
| EMS060250 | 6 | | 0 | 2.5 | 15 | 150 | IV | 1830 +150/-0 |
| EMS070214 | 7 | | 0 | 2.14 | 15 | 150 | IV | 1830 +150/-0 |
| EMS090170 | 9 | | 0 | 1.7 | 15.3 | 150 | IV | 1830 +150/-0 |
| EMS120125 | 12 | | 0 | 1.25 | 15 | 150 | IV | 1830 +150/-0 |
| EMS150100 | 15 | | 0 | 1 | 15 | 150 | IV | 1830 +150/-0 |
| EMS180084 | 18 | | 0 | 0.84 | 15.3 | 150 | IV | 1830 +150/-0 |
| EMS200075 | 20 | | 0 | 0.75 | 15 | 150 | IV | 1830 +150/-0 |
| EMS240063 | 24 | | 0 | 0.63 | 15.1 | 150 | IV | 1830 +150/-0 |

*at full load, 100 ~ 240 V ac input, measured at 20MHz bandwidth with a 10 uF electrolytic cap and a 0.1 uF ceramic cap on the output

PART NUMBER KEY

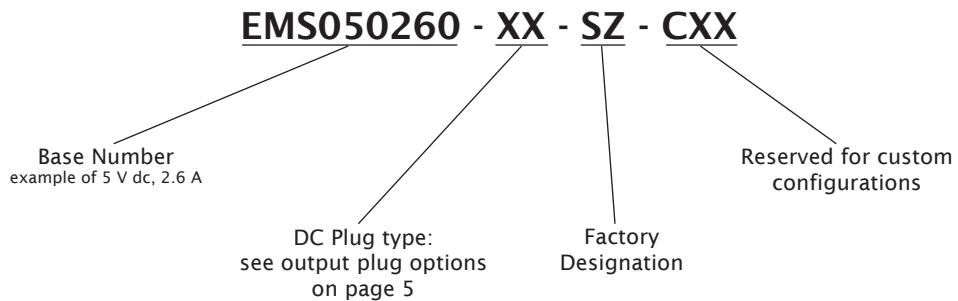



SERIES: 15 W MULTI-BLADE

DESCRIPTION: SWITCHING POWER SUPPLY

INPUT

| parameter | conditions/description | min | nom | max | units |
|---------------------------|--|-----|-----|----------|--------|
| rated input voltage | | 100 | | 240 | V ac |
| input voltage range | | 90 | | 255 | V ac |
| rated frequency | | 50 | | 60 | Hz |
| frequency range | | 47 | | 63 | Hz |
| rated input current | | | | 0.6 | A |
| inrush current | 115 V ac, full load, cold start, 25°C 230 V ac, full load, cold start, 25°C | | | 30 60 | A A |
| no load power consumption | 100 ~ 240 V ac input | | | 0.3 | W |

OUTPUT

| parameter | conditions/description | min | nom | max | units |
|--------------------------|-----------------------------------|------|-----|------|-------|
| line regulation | | | ±1 | | % |
| load regulation | | | ±5 | | % |
| over voltage protection | output shut down | 110% | | 140% | V dc |
| short circuit protection | output shut down and auto-restart | | | | |

SAFETY & EMI

| parameter | conditions/description | min | nom | max | units |
|-----------------------|--|-----|-----|--------------|--------------|
| HI-POT | input to output at 10 mA for 1 second | | | 3000 4242 | V ac V ac |
| insulation resistance | input to output at 500 V dc | 100 | | | MΩ |
| safety approvals | UL/cUL, CB (IEC60950-1), CE (GS/TUV EN60950-1) | | | | |
| EMI standard | FCC part 15 class B, CE (EN55022, EN55024) | | | | |
| leakage current | | | | 0.25 | mA |
| RoHS compliant | yes | | | | |

ENVIRONMENTAL

| parameter | conditions/description | min | nom | max | units |
|-----------------------|------------------------|-----|-----|-----|-------|
| operating temperature | | 0 | | 40 | °C |
| operating humidity | | 20 | | 80 | % |
| storage temperature | | -10 | | 70 | °C |
| storage humidity | | 10 | | 90 | % |



SERIES: 15 W MULTI-BLADE

DESCRIPTION: SWITCHING POWER SUPPLY

MECHANICAL DRAWING

| | |
|------------|---|
| input plug | interchangeable input blade (UL, UK, VDE, SAA) |
| case size | 74 L x 43.5 W x 34 H mm tolerance: ± 1 mm |

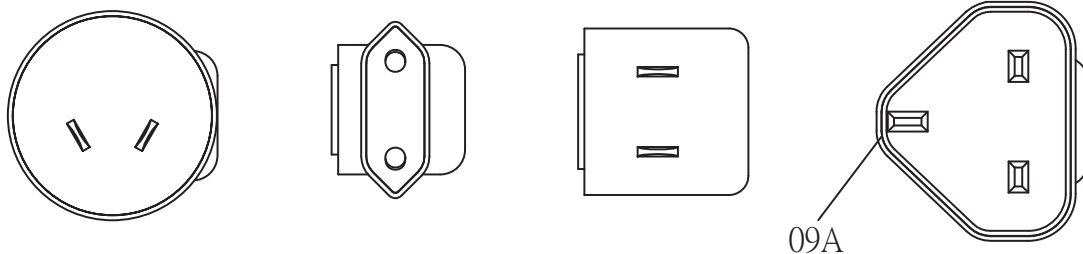
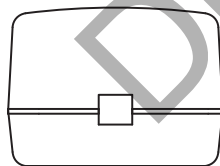
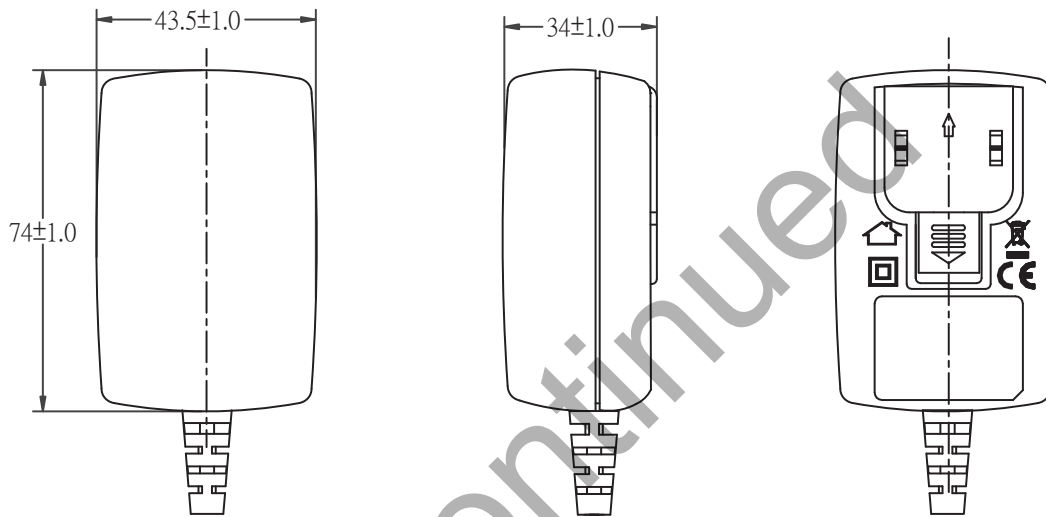



SERIES: 15 W MULTI-BLADE

DESCRIPTION: SWITCHING POWER SUPPLY

DC CORD

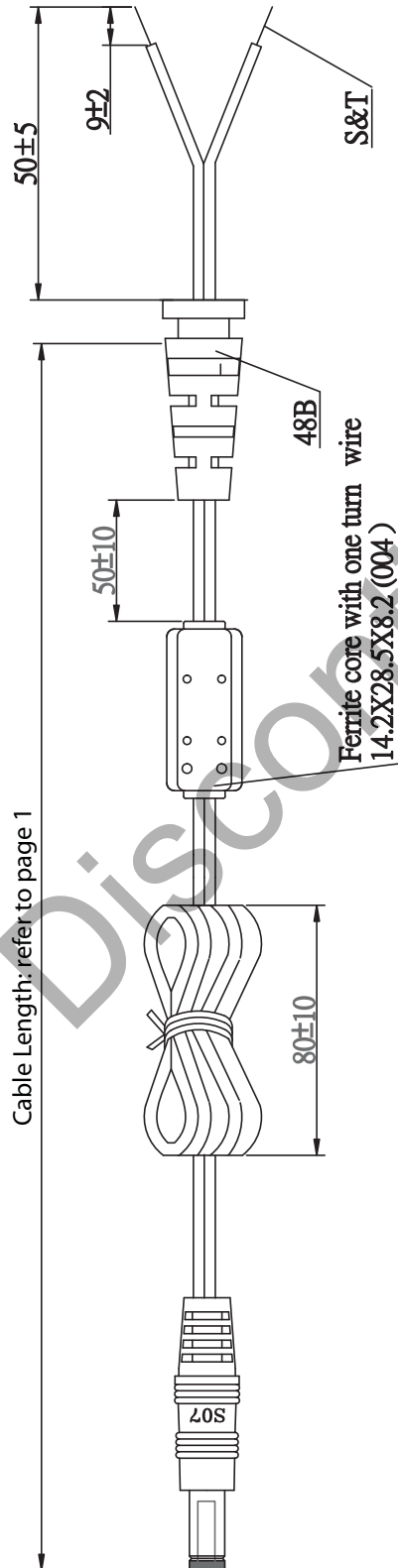

| Cable Gauge | |
|-------------|--------|
| EMS050260 | 18 AWG |
| EMS060250 | 18 AWG |
| EMS070214 | 18 AWG |
| EMS090170 | 20 AWG |
| EMS120125 | 20 AWG |
| EMS150100 | 20 AWG |
| EMS180084 | 20 AWG |
| EMS200075 | 20 AWG |
| EMS240063 | 20 AWG |



SERIES: 15 W MULTI-BLADE

DESCRIPTION: SWITCHING POWER SUPPLY

OUTPUT PLUG OPTIONS

3.5 mm Phono Plug

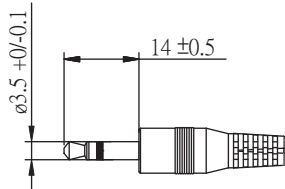

P1

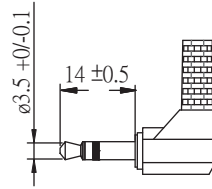

P1R

*Tip positive

Standard DC Plug

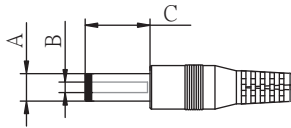

Standard PX

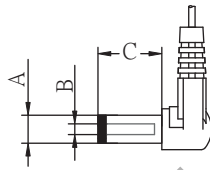

Right Angle PXR

| | A | B | C | Unit |
|--------|-----|------|-----|------|
| P5/P5R | 5.5 | 2.1 | 9.5 | mm |
| P6/P6R | 5.5 | 2.5 | 9.5 | mm |
| P7/P7R | 3.5 | 1.3 | 9.5 | mm |
| P8/P8R | 3.8 | 1.35 | 9.5 | mm |
| P9/P9R | 3.8 | 1.05 | 9.5 | mm |

Locking DC Plug

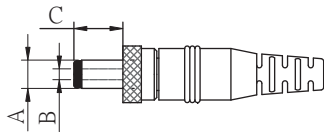

| | A | B | C | Unit |
|-----|-----|-----|-----|------|
| P10 | 5.5 | 2.1 | 9.5 | mm |
| P11 | 5.5 | 2.5 | 9.5 | mm |

EIAJ Plugs

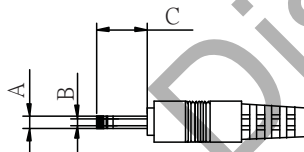

Standard PXX

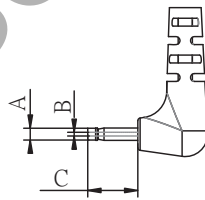

Right Angle PXXR

| | EIAJ | A | B | C | D | Unit |
|----------|--------|------|-----|-----|-----|------|
| P12/P12R | EIAJ-1 | 2.35 | 0.7 | 9.5 | NA | mm |
| P13/P13R | EIAJ-2 | 4.0 | 1.7 | 9.5 | 5.0 | mm |
| P14/P14R | EIAJ-3 | 4.75 | 1.7 | 9.5 | 5.0 | mm |

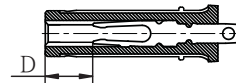

Stripped and Tinned

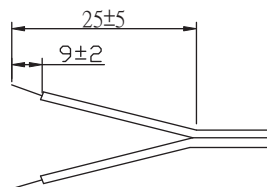

DC PLUG TYPE

ST
stripped and tinned

PXX X X

Plug type Plug angle: "blank" = standard
R = right angle Plug polarity: "blank" = N/A
P = center positive N = center negative

⊖ ⊕ ⊕ ⊖

*Contact CUI for additional output plug options.



SERIES: 15 W MULTI-BLADE

DESCRIPTION: SWITCHING POWER SUPPLY

INDIVIDUAL PACKAGING

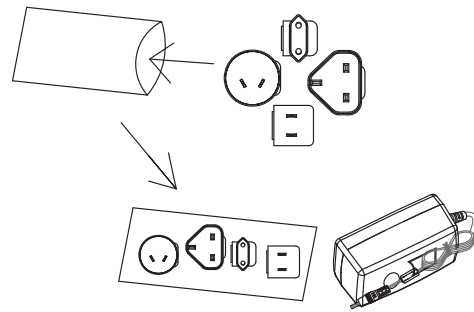

tolerance ± 1 mm

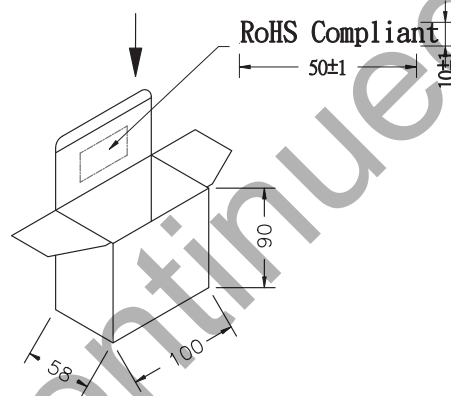

PACKAGING

tolerance $+7 / -0$ mm

CARTON SIZE: 485X428X210mm

Q'TY: 60pcs(20x3x1)

RoHS Compliant

