

Miniature Side Rotary (High Sensitivity) Switches Series 83 137



General specifications Layout



Components

Material

- Case : glass filled polyamide

- Contacts : silver

Actuators

- Stainless steel wire

Operating curve

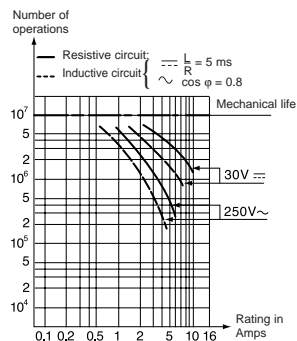

Actuator setting in α

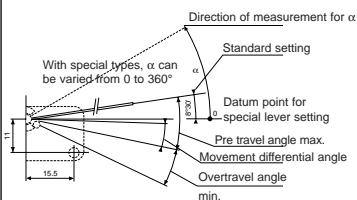

Approvals CSA (LR-20418), ASE, Semko, UTE & VDE.

For other connections, actuators, approvals accessories... Please consult factory

Types

83 137 0

Features

Standard

Electrical characteristics

| | | | |
|-----------------------------|---------|---|----|
| Current rating at 125-250 V | Nominal | A | 5 |
| | Thermal | A | 14 |

Mechanical characteristics

| | | |
|-------------------------|---------------|------------------------|
| Maximum operating force | N cm (in. oz) | 0.12 (.17) |
| Minimum release torque | N cm (in. oz) | 0.03 (.042) |
| Overtravel torque | N cm (in. oz) | 0.5 (.71) |
| Movement differential | ° | 10 ^{+0.4} |
| Overtravel - min. | ° | 12 |
| Operating temperature | °C (F°) | -20 to 125 (-4 to 257) |
| Mechanical life | Operations | 10 ⁷ |
| Contact gap | mm (in) | 0.8 (.031) |
| Weight | g (oz) | 7.2 (.25) |

Contact Type

C (Form C) SPDT

B (Form B) SPNC

A (Form A) SPNO

C

B

A

Connections



2 solder



3 for 1/4" Quick Connects

Dimensions

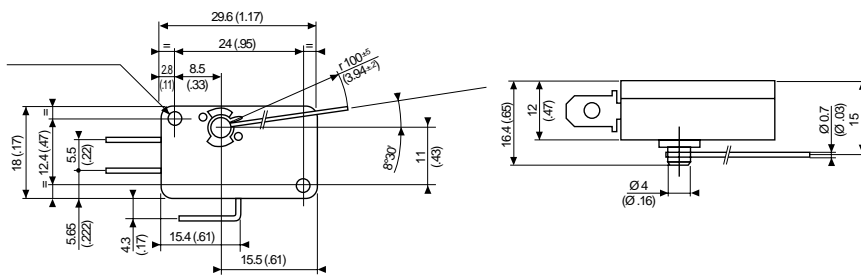

mm (in)

Dimensions connections

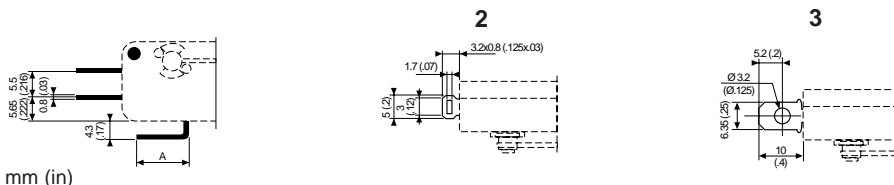

mm (in)

To order, please specify :

Example : 831370 C 3 A W

1 Switch Type

831370

2 Contact Type

A

B

C

3 Connection

2

3

Example switch is: 831370, SPDT, 1/4" Q.C.

Products and specifications subject to change without notice.

Order/Technical Support – Tel: (800) 677-5311 / FAX: (800) 677-3865 / www.crouzet-usa.com