

POS 1 POS 2 POS 3

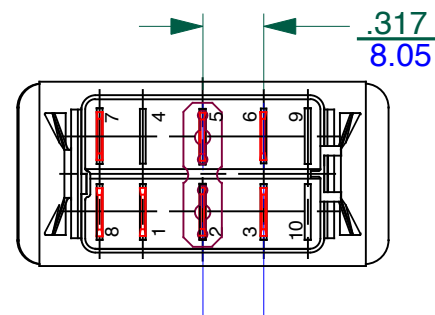
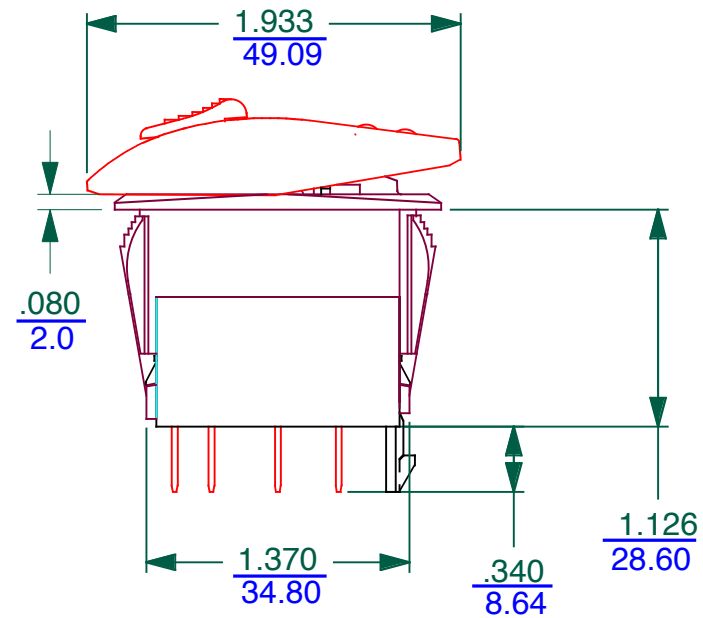
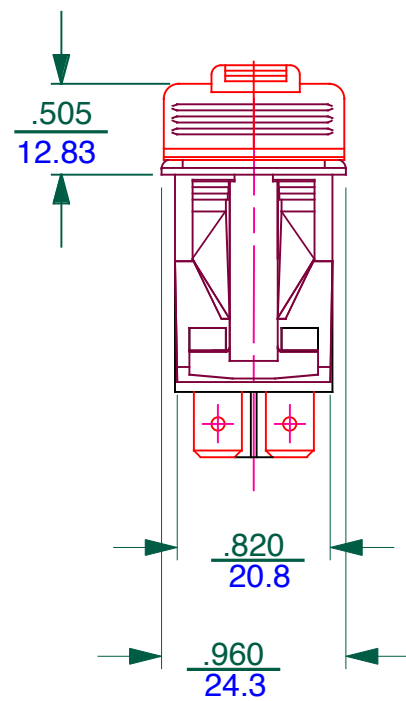

DWG NO.
VX1KXWXX-C8100-000-XBLU1

A diagram of a rectangle with a red border. Above the rectangle, a horizontal dimension line with arrows at both ends is labeled $.830$ in blue. Below the rectangle, a vertical dimension line with arrows at both ends is labeled 36.83 in blue. To the right of the rectangle, there are two calculations. The first calculation is 21.0 in blue, with $.830$ in black above it, and a horizontal line below the blue number. The second calculation is 36.83 in blue, with 1.450 in black above it, and a horizontal line below the blue number.

PANEL THICKNESS
(SNAP - IN BRACKET)
.030 MIN ---- .187 MAX
.76 4.75

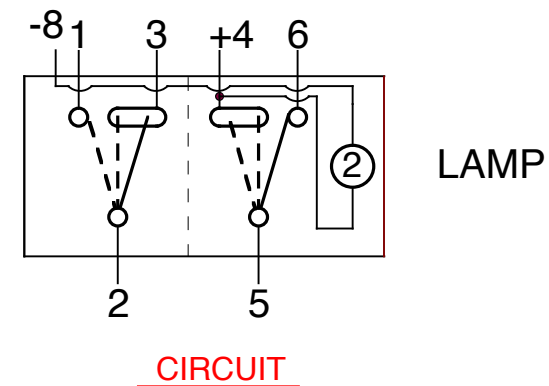

RATING
0.4 VA MAX. @ 28V MAX
(RESISTIVE)

SWITCH FUNCTION		
<u>POS 1</u>	<u>POS 2</u>	<u>POS 3</u>
ON	ON	(ON)
2 TO 3	2 TO 3	2 TO 1
5 TO 6	5 TO 4	5 TO 4

NOTES:

1. BRACKET IS BLACK NYLON
2. ROCKER IS BLACK NYLON WITH WHITE POLYCARBONATE LENS
3. LOCK COLOR IS BLACK
4. 12V BLUE LED T4+ TO T8-
5. SPECIAL BRACKET DESIGNED TO PREVENT ACTUATION FROM POS 2 TO POS 1 ONLY
YOU MUST ACTUATE THE LOCK AND PRESS DOWN ROCKER TO ACTUATE THE SWITCH FROM POS 2 TO POS 1
THE LOCK DOES NOT HAVE TO BE USED TO ACTUATE THE SWITCH FROM POS 2 TO POS 3

NOTICE TO ALL PERSONS RECEIVING
THIS DRAWING. THIS DOCUMENT IS THE
PROPERTY OF CARLINGSWITCH, INC.
AND IS NOT TO BE DISCLOSED,
REPRODUCED IN WHOLE OR IN PART OR
USED FOR MANUFACTURING PURPOSES
BY ANYONE WITHOUT THE CONSENT OF
CARLINGSWITCH, INC.

X.XXX ±.015

10/10

DIMENSIONS
IN [mm]

DR BY

KRAMARZ

APPD BY

DATE
8-8-12

DATE

TITLE	"V" SERIES SWITCH
-------	-------------------

DWG NO.
VX1KXWXX-C8100-000-XBLU1

	USED ON
--	---------

SCALE: **FULL**

SHT 1 OF 1